

WIS - Dacha Relocation Site Logistics Plan  
(Feb 18 - Mar 27 & April 1 - June 19)

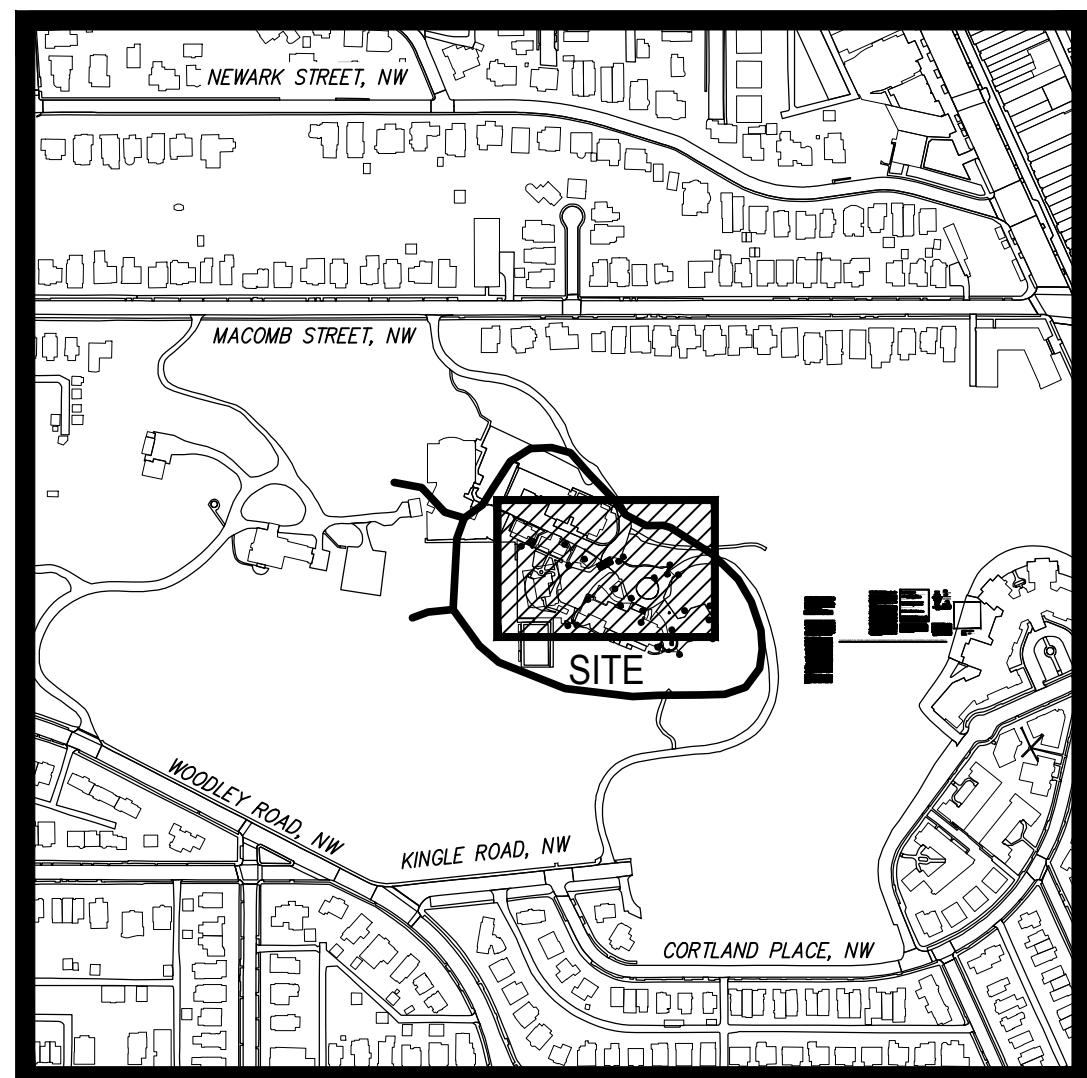

VICINITY MAP  
SCALE: 1"=300'  
SQUARE: 2084 LOT: 841  
ADDRESS: 3100 MACOMB ST NW

EROSION AND SEDIMENT CONTROL NARRATIVE:  
SILT FENCE LOCATED ALONG THE PERIMETER OF THE LIMITS OF DISTURBANCE AND LIMITS OF WORK. STORM INLET PROTECTION TO BE INSTALLED AT INLETS WITHIN THE LOW TO PREVENT SEDIMENT-LOADED WATER FROM ENTERING THE SYSTEM. TREE PROTECTION FENCE USED TO PROTECT ALL PRESERVED TREES.

LIMITS OF WORK (LOW) INCLUDES THE TRAVEL PATH OF THE TRUCK FROM THE EXISTING CURRENT LOCATION OF THE DACHA HOUSE TO THE NEW TEMPORARY RELOCATED AREA. THE LOW WILL BE FLAGGED TO KEEP PEDESTRIANS CLEAR DURING THE RELOCATION OF THE DACHA HOUSE. THE LIMITS OF DISTURBANCE (LOD) INCLUDES EXCAVATION AROUND THE EXISTING DACHA HOUSE AND EARTH MOVING TO LEVEL THE NEW LOCATION, IMPERVIOUS AREAS OF THE TRUCK TRAVEL PATH AS WELL AS AREAS OF TREE AND VEGETATION REMOVAL. ALL LOW/LOD WILL BE ENCLOSED WITH SILT FENCE.

Key  
Pedestrian protected walkways  
Fencing line

LEGEND	PROPOSED
SILT FENCE	SF
INLET PROTECTION	IP
APPROXIMATE LIMIT OF BELOW GRADE EXCAVATION	---
APPROXIMATE LIMIT OF DISTURBANCE	---
TREE PROTECTION	TP
SILT FENCE ON PAVEMENT	SFOP
TEMP CONSTRUCTION ENTRANCE	SC

- PRECONSTRUCTION MEASURES:**
1. ALL EXISTING TREES TO BE PRESERVED AND TO BE REMOVED SHALL BE CLEARLY MARKED ON-SITE PRIOR TO THE APPROVED TREE PRESERVATION PLAN.
  2. INSTALL SEDIMENT AND EROSION CONTROL MEASURES INCLUDING INLET PROTECTION, TREE PROTECTION, AND SILT FENCE AS INDICATED ON SHEET CIV0103. SEE SHEET CIV0104 FOR EROSION AND SEDIMENT CONTROL DETAILS.
  3. SEDIMENT CONTROL MEASURES SHALL BE INSPECTED AND APPROVED BY THE INSPECTOR PRIOR TO COMMENCING ANY OTHER LAND DISTURBING ACTIVITIES.
  4. REMOVE ITEMS AS INDICATED ON DEMOLITION PLAN.
  5. AT THE COMPLETION OF DACHA RELOCATION AND AFTER THE INSPECTOR'S APPROVAL, ALL TEMPORARY SEDIMENTATION AND EROSION CONTROL MEASURES SHALL BE REMOVED.
- EROSION AND SEDIMENT CONTROL NOTE:**
1. THE APPLICANT MUST NOTIFY THE DEPARTMENT OF ENERGY AND ENVIRONMENT BY PHONE (202-535-2977) AT LEAST 72 HOURS PRIOR TO THE START OF LAND DISTURBING ACTIVITY AND WITHIN (2) WEEKS AFTER COMPLETION OF PROJECT TO REQUEST INSPECTION. IF THERE IS NEED TO MAKE CHANGES OR MODIFICATIONS IN THE APPROVED DESIGN, DEPARTMENT OF ENERGY AND ENVIRONMENT MUST BE NOTIFIED IMMEDIATELY.
  2. REMOVAL OF ANY EROSION AND SEDIMENT CONTROL MEASURES REQUIRES APPROVAL FROM DOEE INSPECTOR.
  3. THE CONTRACTOR SHALL BE RESPONSIBLE FOR DESIGN OF SHEETING AND SHORING AND SUPPORT OF EXISTING UTILITIES AND ADJACENT STRUCTURES. SHORING, BRACING, AND UNDERPINNING DESIGNED BY THE CONTRACTOR'S STRUCTURAL ENGINEER LICENSED IN THE DISTRICT OF COLUMBIA SHALL BE PROVIDED AS NECESSARY TO ENSURE THEIR SUPPORT.
  4. PROVIDE SILT FENCE AT PERIMETER OF EXCAVATION AREA TO REMAIN IN PLACE UNTIL BELOW GRADE EXCAVATION HAS BEGUN UNLESS OTHERWISE APPROVED BY THE INSPECTOR.
  5. CONTRACTOR TO PROVIDE ON-SITE APPROVED STAMPED AND SIGNED SEDIMENTATION AND EROSION CONTROL DRAWINGS BY DEPARTMENT OF ENERGY AND ENVIRONMENT, WATERSHED PROTECTION DIVISION.
  6. PROVIDE A CHAIN LINK FENCE AT PERIMETER OF SITE.
  7. NO LATER THAN THE FIRST DAY OF CONSTRUCTION, INSTALL SITE ACCESS MEASURES TO MINIMIZE OFF-SITE VEHICLE TRACKING OF SEDIMENTS. EACH CONSTRUCTION ENTRANCE MUST BE STABILIZED AND INCLUDE EACH ADDITIONAL MEASURES REQUIRED TO KEEP SEDIMENT FROM BEING CARRIED ONTO PUBLIC STREETS BY CONSTRUCTION VEHICLES AND WASHED INTO A STORM DRAIN OR WATERWAY.
  8. REMOVE OFF-SITE ACCUMULATION OF SEDIMENT DAILY DURING CONSTRUCTION AND IMMEDIATELY AT THE REQUEST OF DOEE INSPECTOR.
  9. PERFORM ROUTINE MAINTENANCE TO PREVENT ANY NEW DE-STABILIZATION AREAS.
  10. STRAW BALE DIKES WILL BE REPLACED EVERY THREE (3) MONTHS UNTIL COMMENCEMENT OF CONSTRUCTION.

**TOTAL SITE AREA:**  
TOTAL SITE AREA: 259,702 SF / 5.962 AC

**TOTAL VOLUME OF CUT OF BELOW GRADE EXCAVATION:**  
TOTAL AREA OF EXCAVATION: 2,338 SF / 0.054 AC  
VOLUME OF CUT: (2,338) SQ.FT. (AREA) X (4) FEET (DEPTH)  
27

**VOLUME OF CUT: (346) cy +/-**

**TOTAL VOLUME OF CUT / FILL FOR UTILITIES:**  
TOTAL AREA OF EXCAVATION: SF / AC  
VOLUME OF CUT: ( ) SQ.FT. (AREA) X ( ) FEET (DEPTH)  
27

**VOLUME OF CUT AND FILL: ( ) cy +/-**

**TOTAL AREA OF DISTURBANCE:**  
TOTAL AREA OF DISTURBANCE: 17,197 SQUARE FEET OR 0.395 AC

**CONSTRUCTION DATES:**  
THE PROPOSED WORK DUE TO COMMENCE DECEMBER 2022 AND IS ANTICIPATED TO TAKE APPROXIMATELY 1 WEEK.  
EXACT BEGINNING AND END OF CONSTRUCTION IS TO BE ESTABLISHED BY THE OWNER.

**ENFORCEMENT OF SIGNAGE REQUIREMENT FOR PROJECTS REQUIRING EROSION AND SEDIMENT CONTROL PLANS:**  
ALL CONSTRUCTION PROJECTS REQUIRING SOIL EROSION AND SEDIMENT CONTROL (ESD) PLANS MUST POST A DISTRICT-APPROVED SIGN THAT NOTIFIES THE PUBLIC TO CONTACT DOEE IN THE EVENT OF EROSION OR OTHER POLLUTION FROM THE SITE. DOEE HAS INCREASED ITS ENFORCEMENT EFFORTS FOR THIS REQUIREMENT. A LIMITED NUMBER OF PRE-PRINTED SIGNS IS AVAILABLE AT THE DEPARTMENT OF CONSUMER AND REGULATORY AFFAIRS AND WILL BE ISSUED AT NO CHARGE WITH APPROVED SOIL EROSION AND SEDIMENT CONTROL PLANS ON A FIRST-COME, FIRST-SERVED BASIS. AN ELECTRONIC COPY OF THE DISTRICT APPROVED SIGN IS AVAILABLE AT [HTTP://DOEE.DC.GOV/ESC](http://doee.dc.gov/esc).

30' 15' 0 30' 60'  
1" = 30'

shalom baranes associates architects  
1010 WISCONSIN AVE. NW SUITE 900  
WASHINGTON, DC 20007  
TEL 202.342.2200  
www.shalombaranes.com

CONSULTANTS:  
CIVIL ENGINEER:  
WILES MENSCH DC  
2000 Edmund Hallway Dr Suite 120  
Reston, VA 20191  
703.391.7000  
LANDSCAPE ARCHITECT:  
MICHAEL VERGASON LANDSCAPE ARCHITECTS, LTD.  
907 King Street, Suite 200  
Alexandria, VA 22314  
703.836.5557 | www.vergason.net

STRUCTURAL ENGINEER:  
TADJER COHEN EDELSON  
1501 Farm Credit Drive  
McLean, VA 22102  
571.587.1520

WIS  
DACHA  
BUILDING  
3100 MACOMB ST NW  
WASHINGTON, DC 20016  
OWNER:  
WASHINGTON INTERNATIONAL SCHOOL

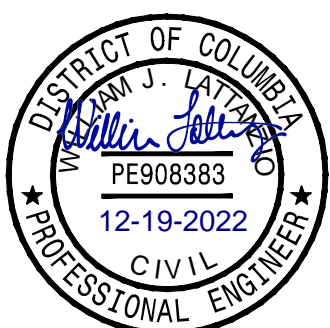

SBA PROJECT NO:  
25109

Erosion and  
Sediment Control  
Plan

SCALE  
AS SHOWN

ISSUED:  
DATE DESCRIPTION  
10-21-22 DACHA FTG PERMIT

REVISIONS:  
DATE DESCRIPTION #

© 2021 Shalom Baranes Associates, PC  
SBA PROJECT NO: 25109

CIV0103

PROGRESS DATE 10/21/2022

THIS SHEET IS TO BE USED FOR SEDIMENTATION AND EROSION CONTROL PURPOSES ONLY